



NRB TEMP UTILITIES

Washington University in St. Louis
SCHOOL OF MEDICINE

McCarthy Contacts

Chris Fava - MEP
785-215-5697

Ben Hackett - MEP
314-281-7339

Jared Hamel - Concrete
618-267-4477

Luke Martin - Concrete
314-703-6694

Scott Naumann - Safety
314-650-7401

Legend

- Electric
- ★ Electric Meter
- ▼ Local Disconnect
- Gas
- ★ Gas Meter
- Water
- ★ Site Shut-Off
- ▼ Spigot

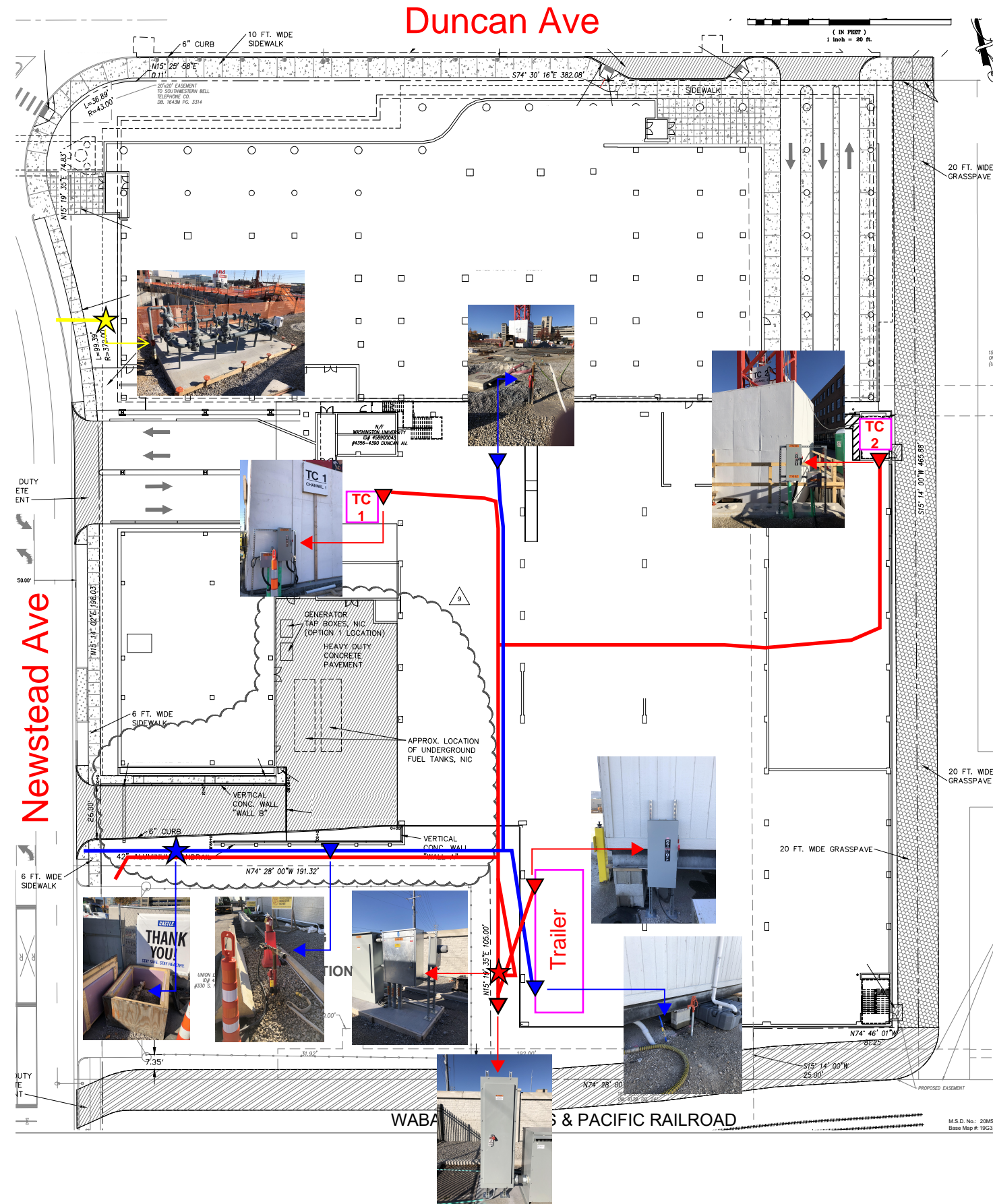

Spire
800-887-4173

Ameren Missouri
800-552-7583

City of St. Louis Water Division
314-633-9000 ext. 1

Immediate Emergencies

WashU Emergency Services
314-362-4357

Utility Service Address

4370 Duncan Ave
St. Louis, MO 63110

